

# PLAZA REC 6CM

PRODUCT NUMBER # 606



- Deeply rounded surfaces combine to create the enduring appeal of stone cobbles formed by glaciers and set by hand
- Versatile 3:2 shape easily forms stacked, runner, and herringbone patterns
- Suitable for medium vehicular applications, such as residential streets and commercial parking lots, with proper pavement design and installation
- Joints and surfaces are designed to create a natural look, minimize furniture wobble, and meet ADA gap and lippage requirements
- Made of durable concrete that won't decay, distort, or attract pests. Iron oxide pigments won't fade with extended UV exposure. Meets or exceeds applicable requirements of ASTM C936 and C1782

The Plaza series features rounded surfaces and edges which recall the timeless appeal of stones worn smooth by glaciers. Designed for random runner, ashlar and decorative patterns, Plaza installs quickly and creates the aesthetic of historical Old World pavements. Plaza pavers are available in an extensive range of sizes and heights to suit a variety of traffic conditions and base preparations, and in layer arrangements to facilitate mechanical installation.

## STONE(S)

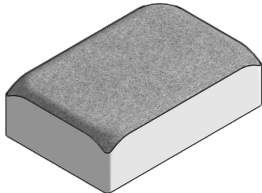

			Rec
<b>Height</b>	<i>in</i>	In.	2.36
	<i>mm</i>	MM.	60
<b>Length</b>	<i>in</i>	IN.	8.27
	<i>mm</i>	MM	210
<b>Width</b>	<i>in</i>	IN	5.51
	<i>mm</i>	MM	140
<b>Units</b>	<i>/pl</i>	QTY	300

## PALLET LAYOUT

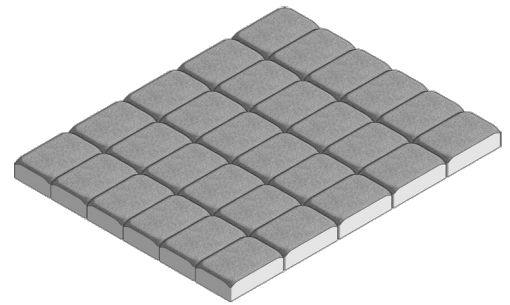

## NOTES

Weights are approximate and do not include shipping pallet. Installation to applicable ICPI standards is required for warranty coverage. Made with natural materials, which vary in color, and Portland cement, which may effloresce - any implied warranty to the contrary is disclaimed.

## PALLET SPECS

<b>Pallet Weight</b>	2522 lbs
<b>Sq Ft/Pallet</b>	95 sq.ft.



Distributed by:



www.aspent.com

(800) 869-9600

www.pavestone.com

# PLAZA REC 6CM

PRODUCT NUMBER # 606Z



- Deeply rounded surfaces combine to create the enduring appeal of stone cobbles formed by glaciers and set by hand
- Versatile 3:2 shape easily forms stacked, runner, and herringbone patterns
- Suitable for medium vehicular applications, such as residential streets and commercial parking lots, with proper pavement design and installation
- Joints and surfaces are designed to create a natural look, minimize furniture wobble, and meet ADA gap and lippage requirements
- Made of durable concrete that won't decay, distort, or attract pests. Iron oxide pigments won't fade with extended UV exposure. Meets or exceeds applicable requirements of ASTM C936 and C1782

The Plaza series features rounded surfaces and edges which recall the timeless appeal of stones worn smooth by glaciers. Designed for random runner, ashlar and decorative patterns, Plaza installs quickly and creates the aesthetic of historical Old World pavements. Plaza pavers are available in an extensive range of sizes and heights to suit a variety of traffic conditions and base preparations, and in layer arrangements to facilitate mechanical installation.

## STONE(S)

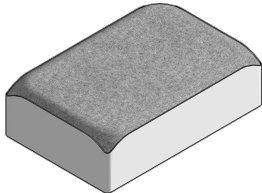

			Rec
<b>Height</b>	<i>in</i>	In.	2.36
	<i>mm</i>	MM.	60
<b>Length</b>	<i>in</i>	IN.	8.27
	<i>mm</i>	MM	210
<b>Width</b>	<i>in</i>	IN	5.51
	<i>mm</i>	MM	140
<b>Units</b>	<i>/pl</i>	QTY	360

## PALLET LAYOUT



## NOTES

Weights are approximate and do not include shipping pallet. Installation to applicable ICPI standards is required for warranty coverage. Made with natural materials, which vary in color, and Portland cement, which may effloresce - any implied warranty to the contrary is disclaimed.

## PALLET SPECS

<b>Pallet Weight</b>	2660 lbs
<b>Sq Ft/Pallet</b>	112 sq.ft.



Distributed by:



www.aspent.com

(800) 869-9600

www.pavestone.com

# PLAZA REC 8CM

PRODUCT NUMBER # 607



- Deeply rounded surfaces combine to create the enduring appeal of stone cobbles formed by glaciers and set by hand
- Versatile 3:2 shape easily forms stacked, runner, and herringbone patterns
- Suitable for heavy vehicular applications, such as municipal streets and minor arterials, with proper pavement design and installation
- Joints and surfaces are designed to create a natural look, minimize furniture wobble, and meet ADA gap and lippage requirements
- Made of durable concrete that won't decay, distort, or attract pests. Iron oxide pigments won't fade with extended UV exposure. Meets or exceeds applicable requirements of ASTM C936 and C1782

The Plaza series features rounded surfaces and edges which recall the timeless appeal of stones worn smooth by glaciers. Designed for random runner, ashlar and decorative patterns, Plaza installs quickly and creates the aesthetic of historical Old World pavements. Plaza pavers are available in an extensive range of sizes and heights to suit a variety of traffic conditions and base preparations, and in layer arrangements to facilitate mechanical installation.

## STONE(S)

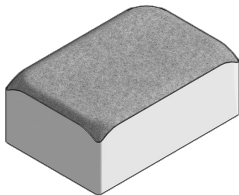

			Rec
<b>Height</b>	<i>in</i>	In.	3.15
	<i>mm</i>	MM.	80
<b>Length</b>	<i>in</i>	IN.	8.27
	<i>mm</i>	MM	210
<b>Width</b>	<i>in</i>	IN	5.51
	<i>mm</i>	MM	140
<b>Units</b>	<i>/pl</i>	QTY	240

## PALLET LAYOUT

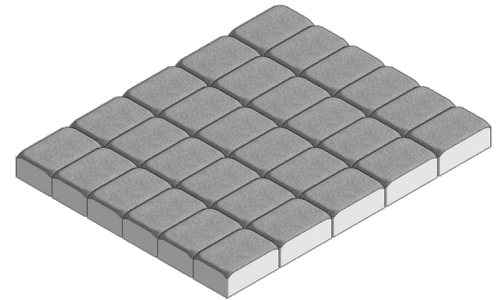

## NOTES

Weights are approximate and do not include shipping pallet. Installation to applicable ICPI standards is required for warranty coverage. Made with natural materials, which vary in color, and Portland cement, which may effloresce - any implied warranty to the contrary is disclaimed.

## PALLET SPECS

<b>Pallet Weight</b>	2736 lbs
<b>Sq Ft/Pallet</b>	76 sq.ft.



Distributed by:



www.aspent.com

(800) 869-9600

www.pavestone.com

# PLAZA TW|SQ|REC 6CM

PRODUCT NUMBER # 610



- Deeply rounded surfaces combine to create the enduring appeal of stone cobbles formed by glaciers and set by hand
- Designed to be installed in a random runner or ashlar pattern, with stones of various, modulating lengths and widths
- Suitable for medium vehicular applications, such as residential streets and commercial parking lots, with proper pavement design and installation
- Joints and surfaces are designed to create a natural look, minimize furniture wobble, and meet ADA gap and lippage requirements
- Made of durable concrete that won't decay, distort, or attract pests. Iron oxide pigments won't fade with extended UV exposure. Meets or exceeds applicable requirements of ASTM C936 and C1782

The Plaza series features rounded surfaces and edges which recall the timeless appeal of stones worn smooth by glaciers. Designed for random runner, ashlar and decorative patterns, Plaza installs quickly and creates the aesthetic of historical Old World pavements. Plaza pavers are available in an extensive range of sizes and heights to suit a variety of traffic conditions and base preparations, and in layer arrangements to facilitate mechanical installation.

## STONE(S)

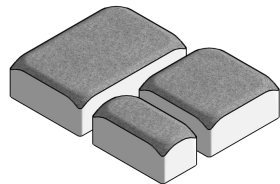

			Twinkie	Square	Rec
<b>Height</b>	<i>in</i>	In.	2.36	2.36	2.36
	<i>mm</i>	MM.	60	60	60
<b>Length</b>	<i>in</i>	IN.	2.76	5.51	8.27
	<i>mm</i>	MM	70	140	210
<b>Width</b>	<i>in</i>	IN	5.51	5.51	5.51
	<i>mm</i>	MM	140	140	140
<b>Units</b>	<i>/pl</i>	QTY	120	180	120

## PALLET LAYOUT

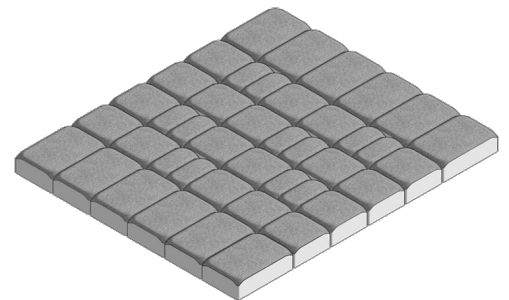

## NOTES

Weights are approximate and do not include shipping pallet. Installation to applicable ICPI standards is required for warranty coverage. Made with natural materials, which vary in color, and Portland cement, which may effloresce - any implied warranty to the contrary is disclaimed.

## PALLET SPECS

<b>Pallet Weight</b>	2492 lbs
<b>Sq Ft/Pallet</b>	89 sq.ft.



Distributed by:

www.aspent.com (800) 869-9600

www.pavestone.com

## PLAZA REC 4.5CM

PRODUCT NUMBER # 612



- Deeply rounded surfaces combine to create the enduring appeal of stone cobbles formed by glaciers and set by hand
- Versatile 3:2 shape easily forms stacked, runner, and herringbone patterns
- Suitable for light vehicular applications, such as residential driveways and parking stalls, with proper pavement design and installation
- Joints and surfaces are designed to create a natural look, minimize furniture wobble, and meet ADA gap and lippage requirements
- Made of durable concrete that won't decay, distort, or attract pests. Iron oxide pigments won't fade with extended UV exposure

The Plaza series features rounded surfaces and edges which recall the timeless appeal of stones worn smooth by glaciers. Designed for random runner, ashlar and decorative patterns, Plaza installs quickly and creates the aesthetic of historical Old World pavements. Plaza pavers are available in an extensive range of sizes and heights to suit a variety of traffic conditions and base preparations, and in layer arrangements to facilitate mechanical installation.

### STONE(S)

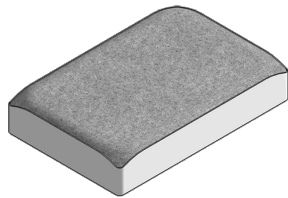

			Rec
<b>Height</b>	<i>in</i>	In.	1.77
	<i>mm</i>	MM.	45
<b>Length</b>	<i>in</i>	IN.	8.27
	<i>mm</i>	MM	210
<b>Width</b>	<i>in</i>	IN	5.51
	<i>mm</i>	MM	140
<b>Units</b>	<i>/pl</i>	QTY	420

### PALLET LAYOUT

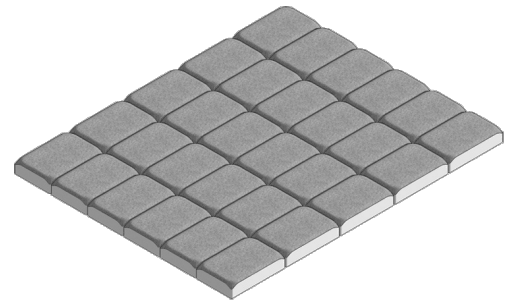

### NOTES

Weights are approximate and do not include shipping pallet. Installation to applicable ICPI standards is required for warranty coverage. Made with natural materials, which vary in color, and Portland cement, which may effloresce - any implied warranty to the contrary is disclaimed.

### PALLET SPECS

<b>Pallet Weight</b>	2783 lbs
<b>Sq Ft/Pallet</b>	133 sq.ft.

**PAVESTONE**<sup>®</sup>  
Creating Beautiful Landscapes<sup>®</sup>

Distributed by:

**ASIP**  
**ENTERPRISES**

www.aspent.com

(800) 869-9600

www.pavestone.com

# PLAZA SQ|REC 6CM

PRODUCT NUMBER # 616



- Deeply rounded surfaces combine to create the enduring appeal of stone cobbles formed by glaciers and set by hand
- Designed to be installed in a random runner or ashlar pattern, with stones of various, modulating lengths and widths
- Suitable for medium vehicular applications, such as residential streets and commercial parking lots, with proper pavement design and installation
- Joints and surfaces are designed to create a natural look, minimize furniture wobble, and meet ADA gap and lippage requirements
- Made of durable concrete that won't decay, distort, or attract pests. Iron oxide pigments won't fade with extended UV exposure. Meets or exceeds applicable requirements of ASTM C936 and C1782

The Plaza series features rounded surfaces and edges which recall the timeless appeal of stones worn smooth by glaciers. Designed for random runner, ashlar and decorative patterns, Plaza installs quickly and creates the aesthetic of historical Old World pavements. Plaza pavers are available in an extensive range of sizes and heights to suit a variety of traffic conditions and base preparations, and in layer arrangements to facilitate mechanical installation.

## STONE(S)

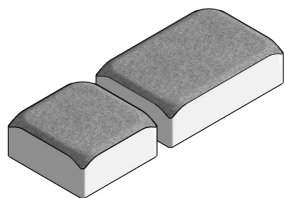

			Square	Rec
<b>Height</b>	<i>in</i>	In.	2.36	2.36
	<i>mm</i>	MM.	60	60
<b>Length</b>	<i>in</i>	IN.	5.51	8.27
	<i>mm</i>	MM	140	210
<b>Width</b>	<i>in</i>	IN	5.51	5.51
	<i>mm</i>	MM	140	140
<b>Units</b>	<i>/pl</i>	QTY	240	180

## PALLET LAYOUT

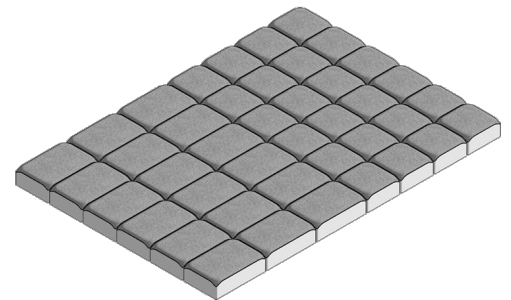

## NOTES

Weights are approximate and do not include shipping pallet. Installation to applicable ICPI standards is required for warranty coverage. Made with natural materials, which vary in color, and Portland cement, which may effloresce - any implied warranty to the contrary is disclaimed.

## PALLET SPECS

<b>Pallet Weight</b>	3080 lbs
<b>Sq Ft/Pallet</b>	108 sq.ft.



Distributed by:

www.aspent.com (800) 869-9600

www.pavestone.com

# PLAZA TW|3/4 6CM

PRODUCT NUMBER # 626



- Deeply rounded surfaces combine to create the enduring appeal of stone cobbles formed by glaciers and set by hand
- Designed to be installed in a random runner or ashlar pattern, with stones of various, modulating lengths and widths
- Suitable for medium vehicular applications, such as residential streets and commercial parking lots, with proper pavement design and installation
- Joints and surfaces are designed to create a natural look, minimize furniture wobble, and meet ADA gap and lippage requirements
- Made of durable concrete that won't decay, distort, or attract pests. Iron oxide pigments won't fade with extended UV exposure. Meets or exceeds applicable requirements of ASTM C936 and C1782

The Plaza series features rounded surfaces and edges which recall the timeless appeal of stones worn smooth by glaciers. Designed for random runner, ashlar and decorative patterns, Plaza installs quickly and creates the aesthetic of historical Old World pavements. Plaza pavers are available in an extensive range of sizes and heights to suit a variety of traffic conditions and base preparations, and in layer arrangements to facilitate mechanical installation.

## STONE(S)

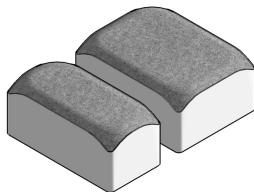

			Twinkie	3/4
<b>Height</b>	<i>in</i>	In.	2.36	2.36
	<i>mm</i>	MM.	60	60
<b>Length</b>	<i>in</i>	IN.	2.76	4.13
	<i>mm</i>	MM	70	105
<b>Width</b>	<i>in</i>	IN	5.51	5.51
	<i>mm</i>	MM	140	140
<b>Units</b>	<i>/pl</i>	QTY	80	560

## PALLET LAYOUT

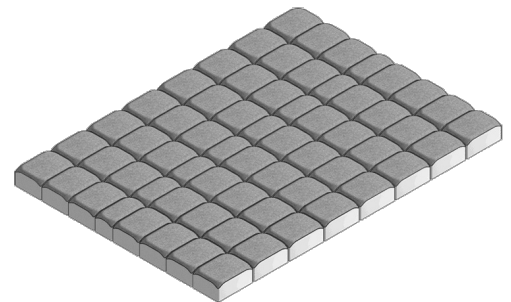

## NOTES

Weights are approximate and do not include shipping pallet. Installation to applicable ICPI standards is required for warranty coverage. Made with natural materials, which vary in color, and Portland cement, which may effloresce - any implied warranty to the contrary is disclaimed.

## PALLET SPECS

<b>Pallet Weight</b>	2619 lbs
<b>Sq Ft/Pallet</b>	97 sq.ft.



Distributed by:

www.aspent.com (800) 869-9600

www.pavestone.com

# PLAZA TW|3/4 6CM

PRODUCT NUMBER # 626Z



- Deeply rounded surfaces combine to create the enduring appeal of stone cobbles formed by glaciers and set by hand
- Designed to be installed in a random runner or ashlar pattern, with stones of various, modulating lengths and widths
- Suitable for medium vehicular applications, such as residential streets and commercial parking lots, with proper pavement design and installation
- Joints and surfaces are designed to create a natural look, minimize furniture wobble, and meet ADA gap and lippage requirements
- Made of durable concrete that won't decay, distort, or attract pests. Iron oxide pigments won't fade with extended UV exposure. Meets or exceeds applicable requirements of ASTM C936 and C1782

The Plaza series features rounded surfaces and edges which recall the timeless appeal of stones worn smooth by glaciers. Designed for random runner, ashlar and decorative patterns, Plaza installs quickly and creates the aesthetic of historical Old World pavements. Plaza pavers are available in an extensive range of sizes and heights to suit a variety of traffic conditions and base preparations, and in layer arrangements to facilitate mechanical installation.

## STONE(S)

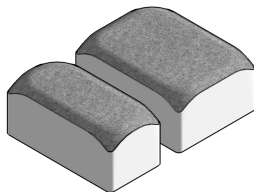

			Twinkie	3/4
<b>Height</b>	<i>in</i>	In.	2.36	2.36
	<i>mm</i>	MM.	60	60
<b>Length</b>	<i>in</i>	IN.	2.76	4.13
	<i>mm</i>	MM	70	105
<b>Width</b>	<i>in</i>	IN	5.51	5.51
	<i>mm</i>	MM	140	140
<b>Units</b>	<i>/pl</i>	QTY	160	560

## PALLET LAYOUT

□

## NOTES

Weights are approximate and do not include shipping pallet. Installation to applicable ICPI standards is required for warranty coverage. Made with natural materials, which vary in color, and Portland cement, which may effloresce - any implied warranty to the contrary is disclaimed.

## PALLET SPECS

**Pallet Weight** 2847 lbs

**Sq Ft/Pallet** 105 sq.ft.



Distributed by:

www.aspent.com (800) 869-9600

www.pavestone.com



# PLAZA TW|SQ|REC 4.5CM

PRODUCT NUMBER # 631



- Deeply rounded surfaces combine to create the enduring appeal of stone cobbles formed by glaciers and set by hand
- Designed to be installed in a random runner or ashlar pattern, with stones of various, modulating lengths and widths
- Suitable for light vehicular applications, such as residential driveways and parking stalls, with proper pavement design and installation
- Joints and surfaces are designed to create a natural look, minimize furniture wobble, and meet ADA gap and lippage requirements
- Made of durable concrete that won't decay, distort, or attract pests. Iron oxide pigments won't fade with extended UV exposure

The Plaza series features rounded surfaces and edges which recall the timeless appeal of stones worn smooth by glaciers. Designed for random runner, ashlar and decorative patterns, Plaza installs quickly and creates the aesthetic of historical Old World pavements. Plaza pavers are available in an extensive range of sizes and heights to suit a variety of traffic conditions and base preparations, and in layer arrangements to facilitate mechanical installation.

## STONE(S)

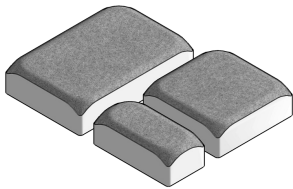

			Twinkie	Square	Rec
<b>Height</b>	<i>in</i>	In.	1.77	1.77	1.77
	<i>mm</i>	MM.	45	45	45
<b>Length</b>	<i>in</i>	IN.	2.76	5.51	8.27
	<i>mm</i>	MM	70	140	210
<b>Width</b>	<i>in</i>	IN	5.51	5.51	5.51
	<i>mm</i>	MM	140	140	140
<b>Units</b>	<i>/pl</i>	QTY	168	252	252

## PALLET LAYOUT

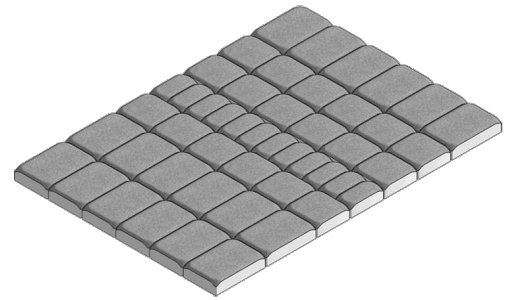

## NOTES

Weights are approximate and do not include shipping pallet. Installation to applicable ICPI standards is required for warranty coverage. Made with natural materials, which vary in color, and Portland cement, which may effloresce - any implied warranty to the contrary is disclaimed.

## PALLET SPECS

<b>Pallet Weight</b>	3136 lbs
<b>Sq Ft/Pallet</b>	148 sq.ft.



Distributed by:



www.aspent.com

(800) 869-9600

www.pavestone.com

# PLAZA FAN 6CM

PRODUCT NUMBER # 636



- Deeply rounded surfaces combine to create the enduring appeal of stone cobbles formed by glaciers and set by hand
- A variety of shapes are combined to form the traditional decorative fan pattern
- Suitable for medium vehicular applications, such as residential streets and commercial parking lots, with proper pavement design and installation
- Joints and surfaces are designed to create a natural look, minimize furniture wobble, and meet ADA gap and lippage requirements
- Made of durable concrete that won't decay, distort, or attract pests. Iron oxide pigments won't fade with extended UV exposure. Meets or exceeds applicable requirements of ASTM C936 and C1782

The Plaza series features rounded surfaces and edges which recall the timeless appeal of stones worn smooth by glaciers. Designed for random runner, ashlar and decorative patterns, Plaza installs quickly and creates the aesthetic of historical Old World pavements. Plaza pavers are available in an extensive range of sizes and heights to suit a variety of traffic conditions and base preparations, and in layer arrangements to facilitate mechanical installation.

## STONE(S)

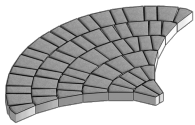

			Twinkie	Wedge L	Wedge R	Trap
<b>Height</b>	<i>in</i>	In.	2.36	2.36	2.36	2.36
	<i>mm</i>	MM.	60	60	60	60
<b>Length</b>	<i>in</i>	IN.	2.76	3.05	3.05	4.65
	<i>mm</i>	MM	70	77.5	77.5	118.1
<b>Width</b>	<i>in</i>	IN	5.51	5.51	5.51	5.51
	<i>mm</i>	MM	140	140	140	140
<b>Units</b>	<i>/pl</i>	QTY	300	120	120	300

## PALLET LAYOUT

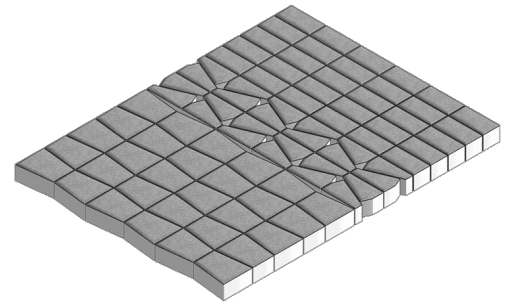

## NOTES

Weights are approximate and do not include shipping pallet. Installation to applicable ICPI standards is required for warranty coverage. Made with natural materials, which vary in color, and Portland cement, which may effloresce - any implied warranty to the contrary is disclaimed.

## PALLET SPECS

<b>Pallet Weight</b>	2646 lbs
<b>Sq Ft/Pallet</b>	102 sq.ft.



Distributed by:

www.aspent.com (800) 869-9600

www.pavestone.com

# PLAZA CIRCLE 6CM

PRODUCT NUMBER # 637



- Deeply rounded surfaces combine to create the enduring appeal of stone cobbles formed by glaciers and set by hand
- A variety of shapes provide maximum creative flexibility for decorative installation patterns ranging from fans to bogens
- Suitable for medium vehicular applications, such as residential streets and commercial parking lots, with proper pavement design and installation
- Joints and surfaces are designed to create a natural look, minimize furniture wobble, and meet ADA gap and lippage requirements
- Made of durable concrete that won't decay, distort, or attract pests. Iron oxide pigments won't fade with extended UV exposure. Meets or exceeds applicable requirements of ASTM C936 and C1782

The Plaza series features rounded surfaces and edges which recall the timeless appeal of stones worn smooth by glaciers. Designed for random runner, ashlar and decorative patterns, Plaza installs quickly and creates the aesthetic of historical Old World pavements. Plaza pavers are available in an extensive range of sizes and heights to suit a variety of traffic conditions and base preparations, and in layer arrangements to facilitate mechanical installation.

## STONE(S)

			Center	Wedge	Trap	Twinkle	3/4
<b>Height</b>	<i>in</i>	IN.	2.36	2.36	2.36	2.36	2.36
	<i>mm</i>	MM.	60	60	60	60	60
<b>Length</b>	<i>in</i>	IN.	2.76	6.18	4.52	2.76	4.13
	<i>mm</i>	MM	70	157	114.7	70	105
<b>Width</b>	<i>in</i>	IN	5.51	5.51	5.51	5.51	5.51
	<i>mm</i>	MM	140	140	140	140	140
<b>Units</b>	<i>/pl</i>	QTY	10	20	280	10	220

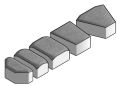

## PALLET LAYOUT

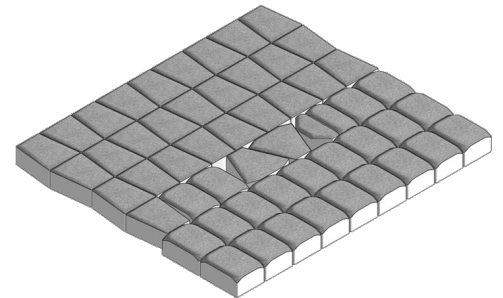

## NOTES

Weights are approximate and do not include shipping pallet. Installation to applicable ICPI standards is required for warranty coverage. Made with natural materials, which vary in color, and Portland cement, which may effloresce - any implied warranty to the contrary is disclaimed.

## PALLET SPECS

<b>Pallet Weight</b>	2239 lbs
<b>Sq Ft/Pallet</b>	84 sq.ft.



Distributed by:

www.aspent.com (800) 869-9600

www.pavestone.com

# PLAZA MUSTER-K 6CM

PRODUCT NUMBER # 638



- Deeply rounded surfaces combine to create the enduring appeal of stone cobbles formed by glaciers and set by hand
- Designed for mechanical installation
- Suitable for medium vehicular applications, such as residential streets and commercial parking lots, with proper pavement design and installation
- Joints and surfaces are designed to create a natural look, minimize furniture wobble, and meet ADA gap and lippage requirements
- Made of durable concrete that won't decay, distort, or attract pests. Iron oxide pigments won't fade with extended UV exposure. Meets or exceeds applicable requirements of ASTM C936 and C1782

The Plaza series features rounded surfaces and edges which recall the timeless appeal of stones worn smooth by glaciers. Designed for random runner, ashlar and decorative patterns, Plaza installs quickly and creates the aesthetic of historical Old World pavements. Plaza pavers are available in an extensive range of sizes and heights to suit a variety of traffic conditions and base preparations, and in layer arrangements to facilitate mechanical installation.

## STONE(S)

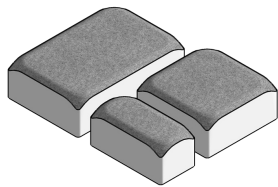

			Twinkie	Square	Rec
<b>Height</b>	<i>in</i>	In.	2.36	2.36	2.36
	<i>mm</i>	MM.	60	60	60
<b>Length</b>	<i>in</i>	IN.	2.76	5.51	8.27
	<i>mm</i>	MM	70	140	210
<b>Width</b>	<i>in</i>	IN	5.51	5.51	5.51
	<i>mm</i>	MM	140	140	140
<b>Units</b>	<i>/pl</i>	QTY	20	170	200

## PALLET LAYOUT

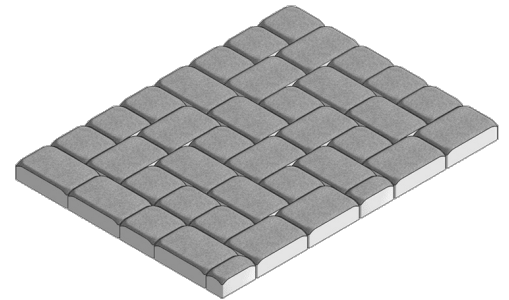

## NOTES

Weights are approximate and do not include shipping pallet. Installation to applicable ICPI standards is required for warranty coverage. Made with natural materials, which vary in color, and Portland cement, which may effloresce - any implied warranty to the contrary is disclaimed.

## PALLET SPECS

<b>Pallet Weight</b>	2800 lbs
<b>Sq Ft/Pallet</b>	100 sq.ft.



Distributed by:



www.aspent.com

(800) 869-9600

www.pavestone.com

# PLAZA MUSTER-K 8CM

PRODUCT NUMBER # 639



- Deeply rounded surfaces combine to create the enduring appeal of stone cobbles formed by glaciers and set by hand
- Designed for mechanical installation
- Suitable for heavy vehicular applications, such as municipal streets and minor arterials, with proper pavement design and installation
- Joints and surfaces are designed to create a natural look, minimize furniture wobble, and meet ADA gap and lippage requirements
- Made of durable concrete that won't decay, distort, or attract pests. Iron oxide pigments won't fade with extended UV exposure. Meets or exceeds applicable requirements of ASTM C936 and C1782

The Plaza series features rounded surfaces and edges which recall the timeless appeal of stones worn smooth by glaciers. Designed for random runner, ashlar and decorative patterns, Plaza installs quickly and creates the aesthetic of historical Old World pavements. Plaza pavers are available in an extensive range of sizes and heights to suit a variety of traffic conditions and base preparations, and in layer arrangements to facilitate mechanical installation.

## STONE(S)

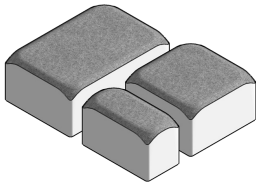

			Twinkie	Square	Rec
<b>Height</b>	<i>in</i>	In.	2.36	2.36	3.15
	<i>mm</i>	MM.	60	60	80
<b>Length</b>	<i>in</i>	IN.	2.76	5.51	8.27
	<i>mm</i>	MM	70	140	210
<b>Width</b>	<i>in</i>	IN	5.51	5.51	5.51
	<i>mm</i>	MM	140	140	140
<b>Units</b>	<i>/pl</i>	QTY	16	136	160

## PALLET LAYOUT

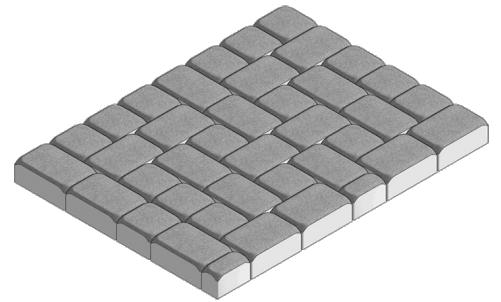

## NOTES

Weights are approximate and do not include shipping pallet. Installation to applicable ICPI standards is required for warranty coverage. Made with natural materials, which vary in color, and Portland cement, which may effloresce - any implied warranty to the contrary is disclaimed.

## PALLET SPECS

<b>Pallet Weight</b>	2979 lbs
<b>Sq Ft/Pallet</b>	80 sq.ft.



Distributed by:

www.aspent.com (800) 869-9600

www.pavestone.com

# PLAZA RUNNER MECH 6CM

PRODUCT NUMBER # 640



- Deeply rounded surfaces combine to create the enduring appeal of stone cobbles formed by glaciers and set by hand
- Designed for mechanical installation
- Suitable for medium vehicular applications, such as residential streets and commercial parking lots, with proper pavement design and installation
- Joints and surfaces are designed to create a natural look, minimize furniture wobble, and meet ADA gap and lippage requirements
- Made of durable concrete that won't decay, distort, or attract pests. Iron oxide pigments won't fade with extended UV exposure. Meets or exceeds applicable requirements of ASTM C936 and C1782

The Plaza series features rounded surfaces and edges which recall the timeless appeal of stones worn smooth by glaciers. Designed for random runner, ashlar and decorative patterns, Plaza installs quickly and creates the aesthetic of historical Old World pavements. Plaza pavers are available in an extensive range of sizes and heights to suit a variety of traffic conditions and base preparations, and in layer arrangements to facilitate mechanical installation.

## STONE(S)

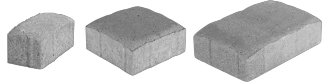

			Twinkie	3/4	Square
<b>Height</b>	<i>in</i>	In.	2.36	2.36	2.36
	<i>mm</i>	MM.	60	60	60
<b>Length</b>	<i>in</i>	IN.	2.76	4.13	5.51
	<i>mm</i>	MM	70	105	140
<b>Width</b>	<i>in</i>	IN	5.51	5.51	5.51
	<i>mm</i>	MM	140	140	140
<b>Units</b>	<i>/pl</i>	QTY	180	240	240

## PALLET LAYOUT

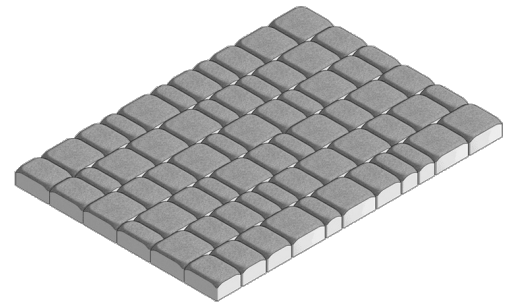

## NOTES

Weights are approximate and do not include shipping pallet. Installation to applicable ICPI standards is required for warranty coverage. Made with natural materials, which vary in color, and Portland cement, which may effloresce - any implied warranty to the contrary is disclaimed.

## PALLET SPECS

<b>Pallet Weight</b>	2940 lbs
<b>Sq Ft/Pallet</b>	105 sq.ft.



Distributed by:

www.aspent.com (800) 869-9600

www.pavestone.com

# PLAZA TW|SQ|REC 6CM

PRODUCT NUMBER # 641



- Deeply rounded surfaces combine to create the enduring appeal of stone cobbles formed by glaciers and set by hand
- Designed to be installed in a random runner or ashlar pattern, with stones of various, modulating lengths and widths
- Suitable for medium vehicular applications, such as residential streets and commercial parking lots, with proper pavement design and installation
- Joints and surfaces are designed to create a natural look, minimize furniture wobble, and meet ADA gap and lippage requirements
- Made of durable concrete that won't decay, distort, or attract pests. Iron oxide pigments won't fade with extended UV exposure. Meets or exceeds applicable requirements of ASTM C936 and C1782

The Plaza series features rounded surfaces and edges which recall the timeless appeal of stones worn smooth by glaciers. Designed for random runner, ashlar and decorative patterns, Plaza installs quickly and creates the aesthetic of historical Old World pavements. Plaza pavers are available in an extensive range of sizes and heights to suit a variety of traffic conditions and base preparations, and in layer arrangements to facilitate mechanical installation.

## STONE(S)

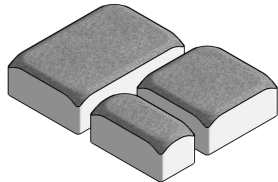

			Twinkie	Square	Rec
<b>Height</b>	<i>in</i>	In.	2.36	2.36	2.36
	<i>mm</i>	MM.	60	60	60
<b>Length</b>	<i>in</i>	IN.	2.76	5.51	8.27
	<i>mm</i>	MM	70	140	210
<b>Width</b>	<i>in</i>	IN	5.51	5.51	5.51
	<i>mm</i>	MM	140	140	140
<b>Units</b>	<i>/pl</i>	QTY	120	180	180

## PALLET LAYOUT

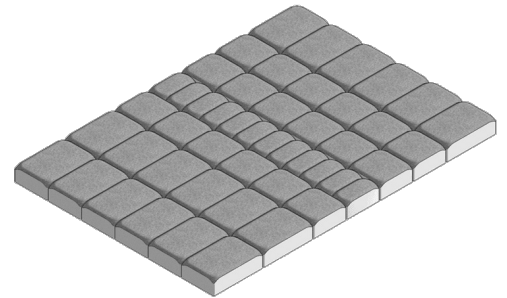

## NOTES

Weights are approximate and do not include shipping pallet. Installation to applicable ICPI standards is required for warranty coverage. Made with natural materials, which vary in color, and Portland cement, which may effloresce - any implied warranty to the contrary is disclaimed.

## PALLET SPECS

<b>Pallet Weight</b>	2971 lbs
<b>Sq Ft/Pallet</b>	106 sq.ft.



Distributed by:



www.aspent.com

(800) 869-9600

www.pavestone.com

## PLAZA SQUARE 4.5CM

PRODUCT NUMBER # 642



- Deeply rounded surfaces combine to create the enduring appeal of stone cobbles formed by glaciers and set by hand
- Square shape easily forms stacked and runner patterns
- Suitable for light vehicular applications, such as residential driveways and parking stalls, with proper pavement design and installation
- Joints and surfaces are designed to create a natural look, minimize furniture wobble, and meet ADA gap and lippage requirements
- Made of durable concrete that won't decay, distort, or attract pests. Iron oxide pigments won't fade with extended UV exposure

The Plaza series features rounded surfaces and edges which recall the timeless appeal of stones worn smooth by glaciers. Designed for random runner, ashlar and decorative patterns, Plaza installs quickly and creates the aesthetic of historical Old World pavements. Plaza pavers are available in an extensive range of sizes and heights to suit a variety of traffic conditions and base preparations, and in layer arrangements to facilitate mechanical installation.

### STONE(S)

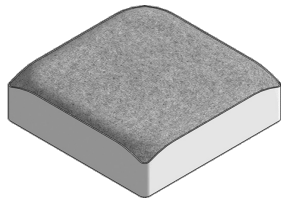

				Square
<b>Height</b>	<i>in</i>	In.		1.77
	<i>mm</i>	MM.		45
<b>Length</b>	<i>in</i>	IN.		5.51
	<i>mm</i>	MM		140
<b>Width</b>	<i>in</i>	IN		5.51
	<i>mm</i>	MM		140
<b>Units</b>	<i>/pl</i>	QTY		672

### PALLET LAYOUT

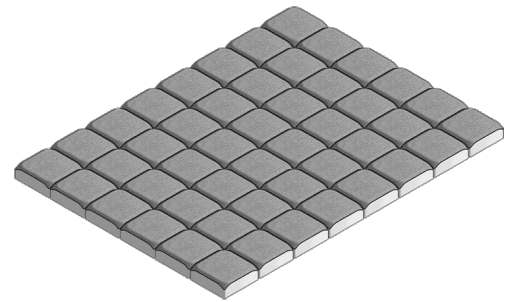

### NOTES

Weights are approximate and do not include shipping pallet. Installation to applicable ICPI standards is required for warranty coverage. Made with natural materials, which vary in color, and Portland cement, which may effloresce - any implied warranty to the contrary is disclaimed.

### PALLET SPECS

<b>Pallet Weight</b>	2940 lbs
<b>Sq Ft/Pallet</b>	140 sq.ft.



www.pavestone.com



## PLAZA TWINKIE 6CM

PRODUCT NUMBER # 644



- Deeply rounded surfaces combine to create the enduring appeal of stone cobbles formed by glaciers and set by hand
- Versatile 2:1 shape easily forms stacked, runner, basketweave, and herringbone patterns
- Suitable for medium vehicular applications, such as residential streets and commercial parking lots, with proper pavement design and installation
- Joints and surfaces are designed to create a natural look, minimize furniture wobble, and meet ADA gap and lippage requirements
- Made of durable concrete that won't decay, distort, or attract pests. Iron oxide pigments won't fade with extended UV exposure. Meets or exceeds applicable requirements of ASTM C936 and C1782

The Plaza series features rounded surfaces and edges which recall the timeless appeal of stones worn smooth by glaciers. Designed for random runner, ashlar and decorative patterns, Plaza installs quickly and creates the aesthetic of historical Old World pavements. Plaza pavers are available in an extensive range of sizes and heights to suit a variety of traffic conditions and base preparations, and in layer arrangements to facilitate mechanical installation.

### STONE(S)

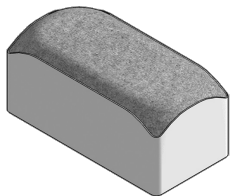

#### Twinkie

<b>Height</b>	<i>in</i>	In.	2.36
	<i>mm</i>	MM.	60
<b>Length</b>	<i>in</i>	IN.	2.76
	<i>mm</i>	MM	70
<b>Width</b>	<i>in</i>	IN	5.51
	<i>mm</i>	MM	140
<b>Units</b>	<i>/pl</i>	QTY	880

### PALLET LAYOUT

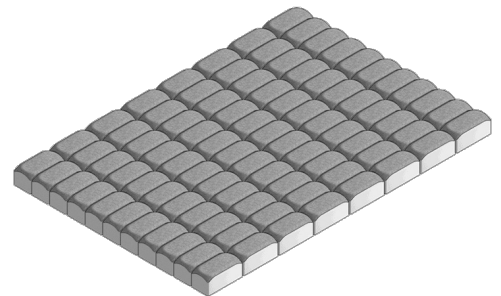

### NOTES

Weights are approximate and do not include shipping pallet. Installation to applicable ICPI standards is required for warranty coverage. Made with natural materials, which vary in color, and Portland cement, which may effloresce - any implied warranty to the contrary is disclaimed.

### PALLET SPECS

<b>Pallet Weight</b>	2716 lbs
<b>Sq Ft/Pallet</b>	97 sq.ft.



www.pavestone.com

# PLAZA TWINKIE 8CM

PRODUCT NUMBER # 645



- Deeply rounded surfaces combine to create the enduring appeal of stone cobbles formed by glaciers and set by hand
- Versatile 2:1 shape easily forms stacked, runner, basketweave, and herringbone patterns
- Suitable for heavy vehicular applications, such as municipal streets and minor arterials, with proper pavement design and installation
- Joints and surfaces are designed to create a natural look, minimize furniture wobble, and meet ADA gap and lippage requirements
- Made of durable concrete that won't decay, distort, or attract pests. Iron oxide pigments won't fade with extended UV exposure. Meets or exceeds applicable requirements of ASTM C936 and C1782

The Plaza series features rounded surfaces and edges which recall the timeless appeal of stones worn smooth by glaciers. Designed for random runner, ashlar and decorative patterns, Plaza installs quickly and creates the aesthetic of historical Old World pavements. Plaza pavers are available in an extensive range of sizes and heights to suit a variety of traffic conditions and base preparations, and in layer arrangements to facilitate mechanical installation.

## STONE(S)

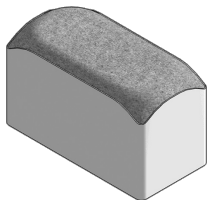

		Twinkie	
<b>Height</b>	<i>in</i>	In.	3.15
	<i>mm</i>	MM.	80
<b>Length</b>	<i>in</i>	IN.	2.76
	<i>mm</i>	MM	70
<b>Width</b>	<i>in</i>	IN	5.51
	<i>mm</i>	MM	140
<b>Units</b>	<i>/pl</i>	QTY	704

## PALLET LAYOUT

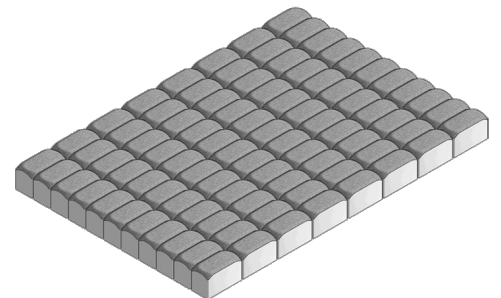

## NOTES

Weights are approximate and do not include shipping pallet. Installation to applicable ICPI standards is required for warranty coverage. Made with natural materials, which vary in color, and Portland cement, which may effloresce - any implied warranty to the contrary is disclaimed.

## PALLET SPECS

<b>Pallet Weight</b>	2808 lbs
<b>Sq Ft/Pallet</b>	78 sq.ft.



Distributed by:

www.aspent.com (800) 869-9600

www.pavestone.com

# PLAZA SQUARE 6CM

PRODUCT NUMBER # 646



- Deeply rounded surfaces combine to create the enduring appeal of stone cobbles formed by glaciers and set by hand
- Square shape easily forms stacked and runner patterns
- Suitable for medium vehicular applications, such as residential streets and commercial parking lots, with proper pavement design and installation
- Joints and surfaces are designed to create a natural look, minimize furniture wobble, and meet ADA gap and lippage requirements
- Made of durable concrete that won't decay, distort, or attract pests. Iron oxide pigments won't fade with extended UV exposure. Meets or exceeds applicable requirements of ASTM C936 and C1782

The Plaza series features rounded surfaces and edges which recall the timeless appeal of stones worn smooth by glaciers. Designed for random runner, ashlar and decorative patterns, Plaza installs quickly and creates the aesthetic of historical Old World pavements. Plaza pavers are available in an extensive range of sizes and heights to suit a variety of traffic conditions and base preparations, and in layer arrangements to facilitate mechanical installation.

## STONE(S)

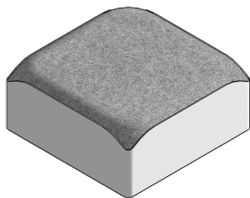

				Square
<b>Height</b>	<i>in</i>	In.		2.36
	<i>mm</i>	MM.		60
<b>Length</b>	<i>in</i>	IN.		5.51
	<i>mm</i>	MM		140
<b>Width</b>	<i>in</i>	IN		5.51
	<i>mm</i>	MM		140
<b>Units</b>	<i>/pl</i>	QTY		480

## PALLET LAYOUT

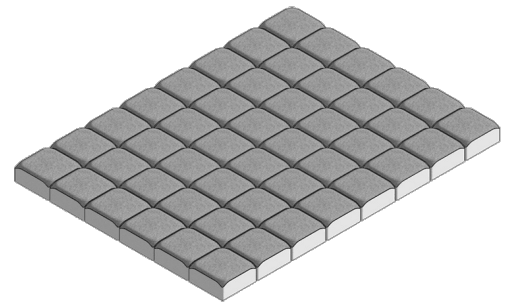

## NOTES

Weights are approximate and do not include shipping pallet. Installation to applicable ICPI standards is required for warranty coverage. Made with natural materials, which vary in color, and Portland cement, which may effloresce - any implied warranty to the contrary is disclaimed.

## PALLET SPECS

<b>Pallet Weight</b>	2678 lbs
<b>Sq Ft/Pallet</b>	100 sq.ft.



Distributed by:



www.aspent.com

(800) 869-9600

www.pavestone.com

# PLAZA GIANT SQUARE 6CM

PRODUCT NUMBER # 647



- Deeply rounded surfaces combine to create the enduring appeal of stone cobbles formed by glaciers and set by hand
- Square shape easily forms stacked and runner patterns
- Suitable for light vehicular applications, such as residential driveways and parking stalls, with proper pavement design and installation
- Joints and surfaces are designed to create a natural look, minimize furniture wobble, and meet ADA gap and lippage requirements
- Made of durable concrete that won't decay, distort, or attract pests. Iron oxide pigments won't fade with extended UV exposure. Meets or exceeds applicable requirements of ASTM C936 and C1782

The Plaza series features rounded surfaces and edges which recall the timeless appeal of stones worn smooth by glaciers. Designed for random runner, ashlar and decorative patterns, Plaza installs quickly and creates the aesthetic of historical Old World pavements. Plaza pavers are available in an extensive range of sizes and heights to suit a variety of traffic conditions and base preparations, and in layer arrangements to facilitate mechanical installation.

## STONE(S)



### Giant Square

<b>Height</b>	<i>in</i>	In.	2.36
	<i>mm</i>	MM.	60
<b>Length</b>	<i>in</i>	IN.	11.02
	<i>mm</i>	MM	280
<b>Width</b>	<i>in</i>	IN	11.02
	<i>mm</i>	MM	280
<b>Units</b>	<i>/pl</i>	QTY	120

## PALLET LAYOUT

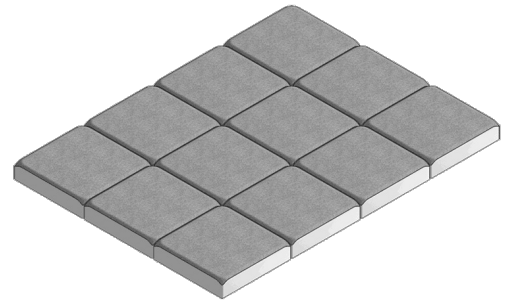

## NOTES

Weights are approximate and do not include shipping pallet. Installation to applicable ICPI standards is required for warranty coverage. Made with natural materials, which vary in color, and Portland cement, which may effloresce - any implied warranty to the contrary is disclaimed.

## PALLET SPECS

<b>Pallet Weight</b>	2800 lbs
<b>Sq Ft/Pallet</b>	100 sq.ft.



Distributed by:



www.aspent.com (800) 869-9600

www.pavestone.com

# PLAZA SQUARE 8CM

PRODUCT NUMBER # 648



- Deeply rounded surfaces combine to create the enduring appeal of stone cobbles formed by glaciers and set by hand
- Square shape easily forms stacked and runner patterns
- Suitable for heavy vehicular applications, such as municipal streets and minor arterials, with proper pavement design and installation
- Joints and surfaces are designed to create a natural look, minimize furniture wobble, and meet ADA gap and lippage requirements
- Made of durable concrete that won't decay, distort, or attract pests. Iron oxide pigments won't fade with extended UV exposure. Meets or exceeds applicable requirements of ASTM C936 and C1782

The Plaza series features rounded surfaces and edges which recall the timeless appeal of stones worn smooth by glaciers. Designed for random runner, ashlar and decorative patterns, Plaza installs quickly and creates the aesthetic of historical Old World pavements. Plaza pavers are available in an extensive range of sizes and heights to suit a variety of traffic conditions and base preparations, and in layer arrangements to facilitate mechanical installation.

## STONE(S)

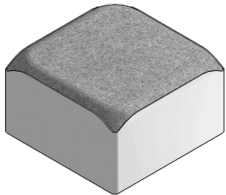

	Square		
<b>Height</b>	<i>in</i>	In.	3.15
	<i>mm</i>	MM.	80
<b>Length</b>	<i>in</i>	IN.	5.51
	<i>mm</i>	MM	140
<b>Width</b>	<i>in</i>	IN	5.51
	<i>mm</i>	MM	140
<b>Units</b>	<i>/pl</i>	QTY	384

## PALLET LAYOUT

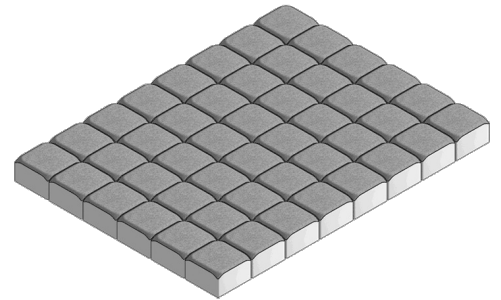

## NOTES

Weights are approximate and do not include shipping pallet. Installation to applicable ICPI standards is required for warranty coverage. Made with natural materials, which vary in color, and Portland cement, which may effloresce - any implied warranty to the contrary is disclaimed.

## PALLET SPECS

<b>Pallet Weight</b>	2880 lbs
<b>Sq Ft/Pallet</b>	80 sq.ft.



Distributed by:



www.aspent.com

(800) 869-9600

www.pavestone.com

# PLAZA GIANT REC 6CM

PRODUCT NUMBER # 649



- Deeply rounded surfaces combine to create the enduring appeal of stone cobbles formed by glaciers and set by hand
- Versatile 4:3 shape easily forms stacked, runner, and herringbone patterns
- Suitable for light vehicular applications, such as residential driveways and parking stalls, with proper pavement design and installation
- Joints and surfaces are designed to create a natural look, minimize furniture wobble, and meet ADA gap and lippage requirements
- Made of durable concrete that won't decay, distort, or attract pests. Iron oxide pigments won't fade with extended UV exposure. Meets or exceeds applicable requirements of ASTM C936 and C1782

The Plaza series features rounded surfaces and edges which recall the timeless appeal of stones worn smooth by glaciers. Designed for random runner, ashlar and decorative patterns, Plaza installs quickly and creates the aesthetic of historical Old World pavements. Plaza pavers are available in an extensive range of sizes and heights to suit a variety of traffic conditions and base preparations, and in layer arrangements to facilitate mechanical installation.

## STONE(S)

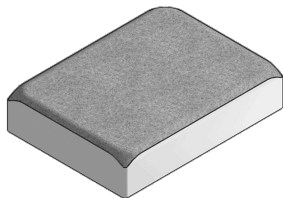

### Giant Rec

<b>Height</b>	<i>in</i>	In.	2.36
	<i>mm</i>	MM.	60
<b>Length</b>	<i>in</i>	IN.	8.27
	<i>mm</i>	MM	210
<b>Width</b>	<i>in</i>	IN	11.02
	<i>mm</i>	MM	280
<b>Units</b>	<i>/pl</i>	QTY	160

## PALLET LAYOUT

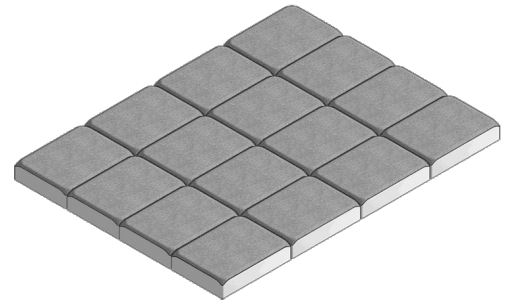

## NOTES

Weights are approximate and do not include shipping pallet. Installation to applicable ICPI standards is required for warranty coverage. Made with natural materials, which vary in color, and Portland cement, which may effloresce - any implied warranty to the contrary is disclaimed.

## PALLET SPECS

<b>Pallet Weight</b>	2828 lbs
<b>Sq Ft/Pallet</b>	101 sq.ft.



Distributed by:



www.aspent.com (800) 869-9600

www.pavestone.com