

## VINTAGE 4X4 6CM

PRODUCT NUMBER # 214



- Smooth surfaces and chamferless edges create the sleekest segmental pavement possible, with crisp elements and tight joints
- Square shape easily forms stacked and runner patterns
- Suitable for medium vehicular applications, such as residential streets and commercial parking lots, with proper pavement design and installation
- Joints and surfaces meet ADA gap and lippage requirements
- Made of durable concrete that won't decay, distort, or attract pests. Iron oxide pigments won't fade with extended UV exposure. Meets or exceeds applicable requirements of ASTM C936 and C1782

The Vintage Stone series removes all topography from stone surfaces and joints, creating a smooth and nearly texture-less pavement to evoke clay or draw attention to color patterns and monolithic fields. Vintage is available in a wide range of paver sizes to suit a variety of installation patterns including random runner, repeating runner and ashlar, and single shape patterns. Vintage is suitable for Rumbling, which weathers the paver stones by breaking and softening edges and corners.

### STONE(S)

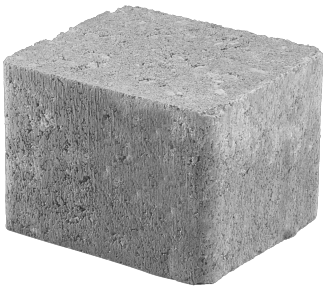

				4x4
<b>Height</b>	<i>in</i>	In.		2.36
	<i>mm</i>	MM.		60
<b>Length</b>	<i>in</i>	IN.		3.94
	<i>mm</i>	MM		100
<b>Width</b>	<i>in</i>	IN		3.94
	<i>mm</i>	MM		100
<b>Units</b>	<i>/pl</i>	QTY		960

### PALLET LAYOUT

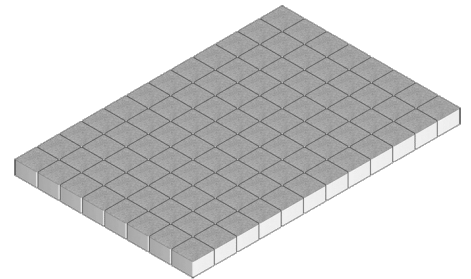

### NOTES

Weights are approximate and do not include shipping pallet. Installation to applicable ICPI standards is required for warranty coverage. Made with natural materials, which vary in color, and Portland cement, which may effloresce - any implied warranty to the contrary is disclaimed.

### PALLET SPECS

<b>Pallet Weight</b>	2884 lbs
<b>Sq Ft/Pallet</b>	103 sq.ft.

**PAVESTONE**  
Creating Beautiful Landscapes®

Distributed by:

**ASIP**  
**ENTERPRISES**

www.aspent.com

(800) 869-9600

www.pavestone.com

## VINTAGE 4X8 4CM

PRODUCT NUMBER # 235



- Smooth surfaces and chamferless edges create the sleekest segmental pavement possible, with crisp elements and tight joints
- Versatile 2:1 shape easily forms stacked, runner, basketweave, and herringbone patterns
- Suitable for behind-curb, pedestrian applications, such as patios and sidewalks, with proper pavement design and installation
- Joints and surfaces meet ADA gap and lippage requirements
- Made of durable concrete that won't decay, distort, or attract pests. Iron oxide pigments won't fade with extended UV exposure

The Vintage Stone series removes all topography from stone surfaces and joints, creating a smooth and nearly texture-less pavement to evoke clay or draw attention to color patterns and monolithic fields. Vintage is available in a wide range of paver sizes to suit a variety of installation patterns including random runner, repeating runner and ashlar, and single shape patterns. Vintage is suitable for Rumbling, which weathers the paver stones by breaking and softening edges and corners.

### STONE(S)

4x8



<b>Height</b>	<i>in</i>	In.	1.57
	<i>mm</i>	MM.	40
<b>Length</b>	<i>in</i>	IN.	7.87
	<i>mm</i>	MM	200
<b>Width</b>	<i>in</i>	IN	3.94
	<i>mm</i>	MM	100
<b>Units</b>	<i>/pl</i>	QTY	720

### PALLET LAYOUT

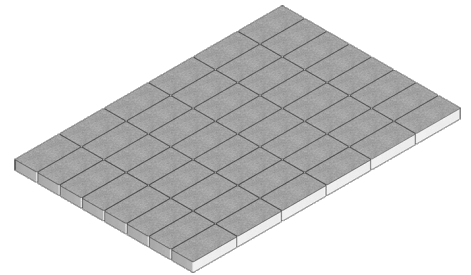

### NOTES

Weights are approximate and do not include shipping pallet. Installation to applicable ICPI standards is required for warranty coverage. Made with natural materials, which vary in color, and Portland cement, which may effloresce - any implied warranty to the contrary is disclaimed.

### PALLET SPECS

<b>Pallet Weight</b>	2800 lbs
<b>Sq Ft/Pallet</b>	155 sq.ft.

**PAVESTONE**  
Creating Beautiful Landscapes®

Distributed by:

**ASIP**  
**ENTERPRISES**

www.aspent.com

(800) 869-9600

www.pavestone.com

## VINTAGE 4X8 6CM

PRODUCT NUMBER # 237



- Smooth surfaces and chamferless edges create the sleekest segmental pavement possible, with crisp elements and tight joints
- Versatile 2:1 shape easily forms stacked, runner, basketweave, and herringbone patterns
- Suitable for medium vehicular applications, such as residential streets and commercial parking lots, with proper pavement design and installation
- Joints and surfaces meet ADA gap and lippage requirements
- Made of durable concrete that won't decay, distort, or attract pests. Iron oxide pigments won't fade with extended UV exposure. Meets or exceeds applicable requirements of ASTM C936 and C1782

The Vintage Stone series removes all topography from stone surfaces and joints, creating a smooth and nearly texture-less pavement to evoke clay or draw attention to color patterns and monolithic fields. Vintage is available in a wide range of paver sizes to suit a variety of installation patterns including random runner, repeating runner and ashlar, and single shape patterns. Vintage is suitable for Rumbling, which weathers the paver stones by breaking and softening edges and corners.

### STONE(S)

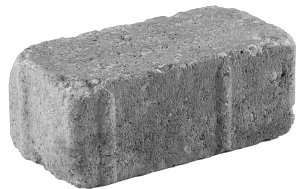

			4x8
<b>Height</b>	<i>in</i>	In.	2.36
	<i>mm</i>	MM.	60
<b>Length</b>	<i>in</i>	IN.	7.87
	<i>mm</i>	MM	200
<b>Width</b>	<i>in</i>	IN	3.94
	<i>mm</i>	MM	100
<b>Units</b>	<i>/pl</i>	QTY	480

### PALLET LAYOUT

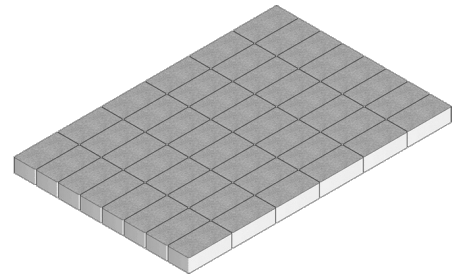

### NOTES

Weights are approximate and do not include shipping pallet. Installation to applicable ICPI standards is required for warranty coverage. Made with natural materials, which vary in color, and Portland cement, which may effloresce - any implied warranty to the contrary is disclaimed.

### PALLET SPECS

<b>Pallet Weight</b>	2884 lbs
<b>Sq Ft/Pallet</b>	103 sq.ft.

**PAVESTONE**<sup>®</sup>  
Creating Beautiful Landscapes<sup>®</sup>

Distributed by:

**AISIP**  
**ENTERPRISES**

www.aspent.com

(800) 869-9600

www.pavestone.com

## VINTAGE 4X8 8CM

PRODUCT NUMBER # 239



- Smooth surfaces and chamferless edges create the sleekest segmental pavement possible, with crisp elements and tight joints
- Versatile 2:1 shape easily forms stacked, runner, basketweave, and herringbone patterns
- Suitable for heavy vehicular applications, such as municipal streets and minor arterials, with proper pavement design and installation
- Joints and surfaces meet ADA gap and lippage requirements
- Made of durable concrete that won't decay, distort, or attract pests. Iron oxide pigments won't fade with extended UV exposure. Meets or exceeds applicable requirements of ASTM C936 and C1782

The Vintage Stone series removes all topography from stone surfaces and joints, creating a smooth and nearly texture-less pavement to evoke clay or draw attention to color patterns and monolithic fields. Vintage is available in a wide range of paver sizes to suit a variety of installation patterns including random runner, repeating runner and ashlar, and single shape patterns. Vintage is suitable for Rumbling, which weathers the paver stones by breaking and softening edges and corners.

### STONE(S)

4x8



<b>Height</b>	<i>in</i>	In.	3.15
	<i>mm</i>	MM.	80
<b>Length</b>	<i>in</i>	IN.	7.87
	<i>mm</i>	MM	200
<b>Width</b>	<i>in</i>	IN	3.94
	<i>mm</i>	MM	100
<b>Units</b>	<i>/pl</i>	QTY	384

### PALLET LAYOUT

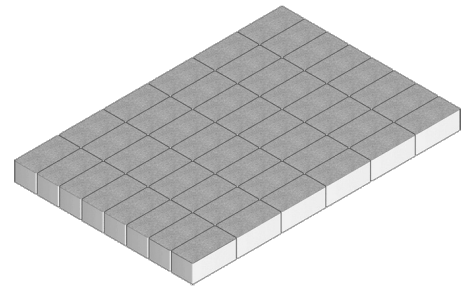

### NOTES

Weights are approximate and do not include shipping pallet. Installation to applicable ICPI standards is required for warranty coverage. Made with natural materials, which vary in color, and Portland cement, which may effloresce - any implied warranty to the contrary is disclaimed.

### PALLET SPECS

<b>Pallet Weight</b>	2996 lbs
<b>Sq Ft/Pallet</b>	83 sq.ft.



Distributed by:



www.aspent.com (800) 869-9600

www.pavestone.com

## VINTAGE 12X12 6CM

PRODUCT NUMBER # 273



- Smooth surfaces and chamferless edges create the sleekest segmental pavement possible, with crisp elements and tight joints
- Square shape easily forms stacked and runner patterns
- Suitable for light vehicular applications, such as residential driveways and parking stalls, with proper pavement design and installation
- Joints and surfaces meet ADA gap and lippage requirements
- Made of durable concrete that won't decay, distort, or attract pests. Iron oxide pigments won't fade with extended UV exposure. Meets or exceeds applicable requirements of ASTM C936 and C1782

The Vintage Stone series removes all topography from stone surfaces and joints, creating a smooth and nearly texture-less pavement to evoke clay or draw attention to color patterns and monolithic fields. Vintage is available in a wide range of paver sizes to suit a variety of installation patterns including random runner, repeating runner and ashlar, and single shape patterns. Vintage is suitable for Rumbling, which weathers the paver stones by breaking and softening edges and corners.

### STONE(S)



			12x12
<b>Height</b>	<i>in</i>	In.	2.36
	<i>mm</i>	MM.	60
<b>Length</b>	<i>in</i>	IN.	11.81
	<i>mm</i>	MM	300
<b>Width</b>	<i>in</i>	IN	11.81
	<i>mm</i>	MM	300
<b>Units</b>	<i>/pl</i>	QTY	120

### PALLET LAYOUT

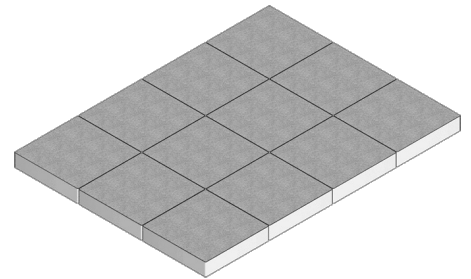

### NOTES

Weights are approximate and do not include shipping pallet. Installation to applicable ICPI standards is required for warranty coverage. Made with natural materials, which vary in color, and Portland cement, which may effloresce - any implied warranty to the contrary is disclaimed.

### PALLET SPECS

<b>Pallet Weight</b>	3360 lbs
<b>Sq Ft/Pallet</b>	120 sq.ft.

**PAVESTONE**  
Creating Beautiful Landscapes®

Distributed by:

**ASIP**  
**ENTERPRISES**

www.aspent.com

(800) 869-9600

www.pavestone.com

## VINTAGE 9X9 6CM

PRODUCT NUMBER # 280



- Smooth surfaces and chamferless edges create the sleekest segmental pavement possible, with crisp elements and tight joints
- Square shape easily forms stacked and runner patterns
- Suitable for medium vehicular applications, such as residential streets and commercial parking lots, with proper pavement design and installation
- Joints and surfaces meet ADA gap and lippage requirements
- Made of durable concrete that won't decay, distort, or attract pests. Iron oxide pigments won't fade with extended UV exposure. Meets or exceeds applicable requirements of ASTM C936 and C1782

The Vintage Stone series removes all topography from stone surfaces and joints, creating a smooth and nearly texture-less pavement to evoke clay or draw attention to color patterns and monolithic fields. Vintage is available in a wide range of paver sizes to suit a variety of installation patterns including random runner, repeating runner and ashlar, and single shape patterns. Vintage is suitable for Rumbling, which weathers the paver stones by breaking and softening edges and corners.

### STONE(S)

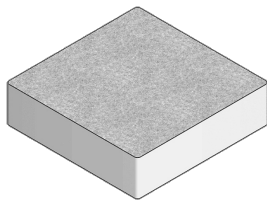

				9x9
<b>Height</b>	<i>in</i>	In.		2.36
	<i>mm</i>	MM.		60
<b>Length</b>	<i>in</i>	IN.		8.86
	<i>mm</i>	MM		225
<b>Width</b>	<i>in</i>	IN		8.86
	<i>mm</i>	MM		225
<b>Units</b>	<i>/pl</i>	QTY		200

### PALLET LAYOUT

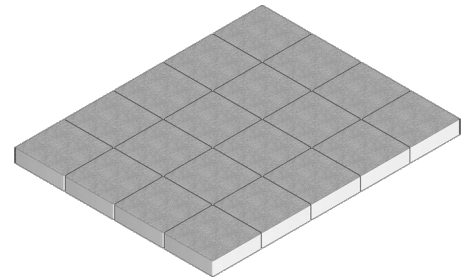

### NOTES

Weights are approximate and do not include shipping pallet. Installation to applicable ICPI standards is required for warranty coverage. Made with natural materials, which vary in color, and Portland cement, which may effloresce - any implied warranty to the contrary is disclaimed.

### PALLET SPECS

<b>Pallet Weight</b>	3080 lbs
<b>Sq Ft/Pallet</b>	110 sq.ft.

**PAVESTONE**  
Creating Beautiful Landscapes®

Distributed by:

**ASIP**  
**ENTERPRISES**

www.aspent.com

(800) 869-9600

www.pavestone.com

## VINTAGE 6X6 6CM

PRODUCT NUMBER # 282



- Smooth surfaces and chamferless edges create the sleekest segmental pavement possible, with crisp elements and tight joints
- Square shape easily forms stacked and runner patterns
- Suitable for medium vehicular applications, such as residential streets and commercial parking lots, with proper pavement design and installation
- Joints and surfaces meet ADA gap and lippage requirements
- Made of durable concrete that won't decay, distort, or attract pests. Iron oxide pigments won't fade with extended UV exposure. Meets or exceeds applicable requirements of ASTM C936 and C1782

The Vintage Stone series removes all topography from stone surfaces and joints, creating a smooth and nearly texture-less pavement to evoke clay or draw attention to color patterns and monolithic fields. Vintage is available in a wide range of paver sizes to suit a variety of installation patterns including random runner, repeating runner and ashlar, and single shape patterns. Vintage is suitable for Rumbling, which weathers the paver stones by breaking and softening edges and corners.

### STONE(S)



				6x6
<b>Height</b>	<i>in</i>	In.		2.36
	<i>mm</i>	MM.		60
<b>Length</b>	<i>in</i>	IN.		5.91
	<i>mm</i>	MM		150
<b>Width</b>	<i>in</i>	IN		5.91
	<i>mm</i>	MM		150
<b>Units</b>	<i>/pl</i>	QTY		400

### PALLET LAYOUT

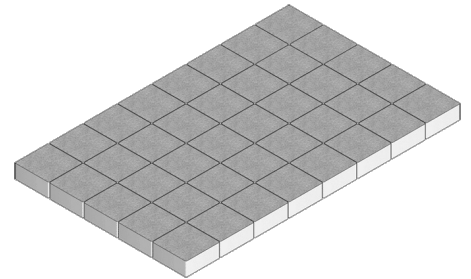

### NOTES

Weights are approximate and do not include shipping pallet. Installation to applicable ICPI standards is required for warranty coverage. Made with natural materials, which vary in color, and Portland cement, which may effloresce - any implied warranty to the contrary is disclaimed.

### PALLET SPECS

<b>Pallet Weight</b>	2640 lbs
<b>Sq Ft/Pallet</b>	97 sq.ft.

**PAVESTONE**  
Creating Beautiful Landscapes®

Distributed by:

**ASIP**  
**ENTERPRISES**

www.aspent.com

(800) 869-9600

www.pavestone.com

## VINTAGE 6X6 6CM

PRODUCT NUMBER # 285



- Smooth surfaces and chamferless edges create the sleekest segmental pavement possible, with crisp elements and tight joints
- Square shape easily forms stacked and runner patterns
- Suitable for medium vehicular applications, such as residential streets and commercial parking lots, with proper pavement design and installation
- Joints and surfaces meet ADA gap and lippage requirements
- Made of durable concrete that won't decay, distort, or attract pests. Iron oxide pigments won't fade with extended UV exposure. Meets or exceeds applicable requirements of ASTM C936 and C1782

The Vintage Stone series removes all topography from stone surfaces and joints, creating a smooth and nearly texture-less pavement to evoke clay or draw attention to color patterns and monolithic fields. Vintage is available in a wide range of paver sizes to suit a variety of installation patterns including random runner, repeating runner and ashlar, and single shape patterns. Vintage is suitable for Rumbling, which weathers the paver stones by breaking and softening edges and corners.

### STONE(S)

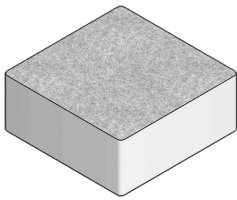

				6x6
<b>Height</b>	<i>in</i>	In.		2.36
	<i>mm</i>	MM.		60
<b>Length</b>	<i>in</i>	IN.		5.91
	<i>mm</i>	MM		150
<b>Width</b>	<i>in</i>	IN		5.91
	<i>mm</i>	MM		150
<b>Units</b>	<i>/pl</i>	QTY		480

### PALLET LAYOUT

□

### NOTES

Weights are approximate and do not include shipping pallet. Installation to applicable ICPI standards is required for warranty coverage. Made with natural materials, which vary in color, and Portland cement, which may effloresce - any implied warranty to the contrary is disclaimed.

### PALLET SPECS

<b>Pallet Weight</b>	3163 lbs
<b>Sq Ft/Pallet</b>	116 sq.ft.

**PAVESTONE**<sup>®</sup>  
Creating Beautiful Landscapes<sup>®</sup>

Distributed by:

**ASIP**  
**ENTERPRISES**

www.aspent.com

(800) 869-9600

www.pavestone.com



# VINTAGE 6X3|6 6CM

PRODUCT NUMBER # 291



- Smooth surfaces and chamferless edges create the sleekest segmental pavement possible, with crisp elements and tight joints
- Designed to be installed in a random runner or ashlar pattern, with stones of various, modulating lengths and widths
- Suitable for medium vehicular applications, such as residential streets and commercial parking lots, with proper pavement design and installation
- Joints and surfaces meet ADA gap and lippage requirements
- Made of durable concrete that won't decay, distort, or attract pests. Iron oxide pigments won't fade with extended UV exposure. Meets or exceeds applicable requirements of ASTM C936 and C1782

The Vintage Stone series removes all topography from stone surfaces and joints, creating a smooth and nearly texture-less pavement to evoke clay or draw attention to color patterns and monolithic fields. Vintage is available in a wide range of paver sizes to suit a variety of installation patterns including random runner, repeating runner and ashlar, and single shape patterns. Vintage is suitable for Rumbling, which weathers the paver stones by breaking and softening edges and corners.

## STONE(S)

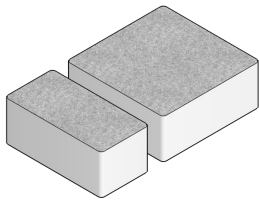

			3x6	6x6
<b>Height</b>	<i>in</i>	In.	2.36	2.36
	<i>mm</i>	MM.	60	60
<b>Length</b>	<i>in</i>	IN.	2.95	5.91
	<i>mm</i>	MM	75	150
<b>Width</b>	<i>in</i>	IN	5.91	5.91
	<i>mm</i>	MM	150	150
<b>Units</b>	<i>/pl</i>	QTY	240	320

## PALLET LAYOUT

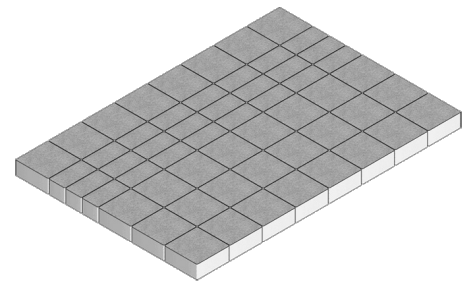

## NOTES

Weights are approximate and do not include shipping pallet. Installation to applicable ICPI standards is required for warranty coverage. Made with natural materials, which vary in color, and Portland cement, which may effloresce - any implied warranty to the contrary is disclaimed.

## PALLET SPECS

<b>Pallet Weight</b>	2968 lbs
<b>Sq Ft/Pallet</b>	106 sq.ft.



Distributed by:



www.aspent.com (800) 869-9600

www.pavestone.com

## VINTAGE 6X3|6 6CM

PRODUCT NUMBER # 291Z



- Smooth surfaces and chamferless edges create the sleekest segmental pavement possible, with crisp elements and tight joints
- Designed to be installed in a random runner or ashlar pattern, with stones of various, modulating lengths and widths
- Suitable for medium vehicular applications, such as residential streets and commercial parking lots, with proper pavement design and installation
- Joints and surfaces meet ADA gap and lippage requirements
- Made of durable concrete that won't decay, distort, or attract pests. Iron oxide pigments won't fade with extended UV exposure. Meets or exceeds applicable requirements of ASTM C936 and C1782

The Vintage Stone series removes all topography from stone surfaces and joints, creating a smooth and nearly texture-less pavement to evoke clay or draw attention to color patterns and monolithic fields. Vintage is available in a wide range of paver sizes to suit a variety of installation patterns including random runner, repeating runner and ashlar, and single shape patterns. Vintage is suitable for Rumbling, which weathers the paver stones by breaking and softening edges and corners.

### STONE(S)

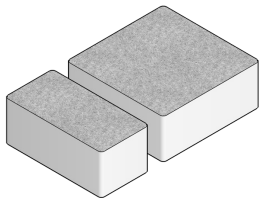

			3x6	6x6
<b>Height</b>	<i>in</i>	In.	2.36	2.36
	<i>mm</i>	MM.	60	60
<b>Length</b>	<i>in</i>	IN.	2.95	5.91
	<i>mm</i>	MM	75	150
<b>Width</b>	<i>in</i>	IN	5.91	5.91
	<i>mm</i>	MM	150	150
<b>Units</b>	<i>/pl</i>	QTY	320	320

### PALLET LAYOUT

□

### NOTES

Weights are approximate and do not include shipping pallet. Installation to applicable ICPI standards is required for warranty coverage. Made with natural materials, which vary in color, and Portland cement, which may effloresce - any implied warranty to the contrary is disclaimed.

### PALLET SPECS

**Pallet Weight** 3164 lbs

**Sq Ft/Pallet** 113 sq.ft.

**PAVESTONE**  
Creating Beautiful Landscapes®

Distributed by:

**AISIP**  
**ENTERPRISES**

www.aspent.com

(800) 869-9600

www.pavestone.com

## VINTAGE 6X9 6CM

PRODUCT NUMBER # 292



- Smooth surfaces and chamferless edges create the sleekest segmental pavement possible, with crisp elements and tight joints
- Versatile 3:2 shape easily forms stacked, runner, and herringbone patterns
- Suitable for medium vehicular applications, such as residential streets and commercial parking lots, with proper pavement design and installation
- Joints and surfaces meet ADA gap and lippage requirements
- Made of durable concrete that won't decay, distort, or attract pests. Iron oxide pigments won't fade with extended UV exposure. Meets or exceeds applicable requirements of ASTM C936 and C1782

The Vintage Stone series removes all topography from stone surfaces and joints, creating a smooth and nearly texture-less pavement to evoke clay or draw attention to color patterns and monolithic fields. Vintage is available in a wide range of paver sizes to suit a variety of installation patterns including random runner, repeating runner and ashlar, and single shape patterns. Vintage is suitable for Rumbling, which weathers the paver stones by breaking and softening edges and corners.

### STONE(S)

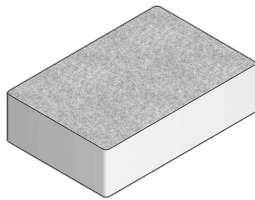

				6x9
<b>Height</b>	<i>in</i>	In.		2.36
	<i>mm</i>	MM.		60
<b>Length</b>	<i>in</i>	IN.		8.86
	<i>mm</i>	MM		225
<b>Width</b>	<i>in</i>	IN		5.91
	<i>mm</i>	MM		150
<b>Units</b>	<i>/pl</i>	QTY		250

### PALLET LAYOUT

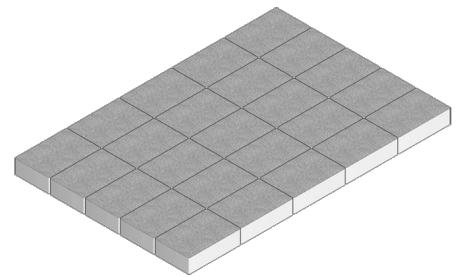

### NOTES

Weights are approximate and do not include shipping pallet. Installation to applicable ICPI standards is required for warranty coverage. Made with natural materials, which vary in color, and Portland cement, which may effloresce - any implied warranty to the contrary is disclaimed.

### PALLET SPECS

<b>Pallet Weight</b>	2520 lbs
<b>Sq Ft/Pallet</b>	90 sq.ft.

**PAVESTONE**  
Creating Beautiful Landscapes®

Distributed by:

**ASIP**  
**ENTERPRISES**

www.aspent.com

(800) 869-9600

www.pavestone.com

# VINTAGE 6X3|6|9 6CM

PRODUCT NUMBER # 293



- Smooth surfaces and chamferless edges create the sleekest segmental pavement possible, with crisp elements and tight joints
- Designed to be installed in an efficient repeating runner or ashlar pattern, with equal numbers of 1/2, square, and 3/2 stones
- Suitable for medium vehicular applications, such as residential streets and commercial parking lots, with proper pavement design and installation
- Joints and surfaces meet ADA gap and lippage requirements
- Made of durable concrete that won't decay, distort, or attract pests. Iron oxide pigments won't fade with extended UV exposure. Meets or exceeds applicable requirements of ASTM C936 and C1782

The Vintage Stone series removes all topography from stone surfaces and joints, creating a smooth and nearly texture-less pavement to evoke clay or draw attention to color patterns and monolithic fields. Vintage is available in a wide range of paver sizes to suit a variety of installation patterns including random runner, repeating runner and ashlar, and single shape patterns. Vintage is suitable for Rumbling, which weathers the paver stones by breaking and softening edges and corners.

## STONE(S)

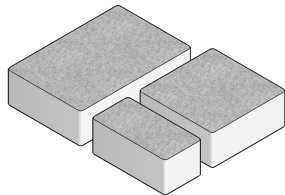

			3x6	6x6	6x9
<b>Height</b>	<i>in</i>	In.	2.36	2.36	2.36
	<i>mm</i>	MM.	60	60	60
<b>Length</b>	<i>in</i>	IN.	2.95	5.91	8.86
	<i>mm</i>	MM	75	150	225
<b>Width</b>	<i>in</i>	IN	5.91	5.91	5.91
	<i>mm</i>	MM	150	150	150
<b>Units</b>	<i>/pl</i>	QTY	160	160	160

## PALLET LAYOUT

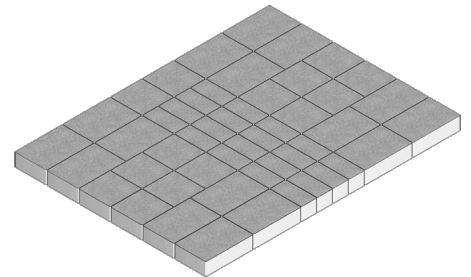

## NOTES

Weights are approximate and do not include shipping pallet. Installation to applicable ICPI standards is required for warranty coverage. Made with natural materials, which vary in color, and Portland cement, which may effloresce - any implied warranty to the contrary is disclaimed.

## PALLET SPECS

<b>Pallet Weight</b>	3248 lbs
<b>Sq Ft/Pallet</b>	116 sq.ft.



[www.pavestone.com](http://www.pavestone.com)

## VINTAGE RUNNER 6CM

PRODUCT NUMBER # 401



- Smooth surfaces and chamferless edges create the sleekest segmental pavement possible, with crisp elements and tight joints
- Designed for the traditional and efficient random runner bond installation pattern, with common stone widths and various lengths
- Suitable for medium vehicular applications, such as residential streets and commercial parking lots, with proper pavement design and installation
- Joints and surfaces meet ADA gap and lippage requirements
- Made of durable concrete that won't decay, distort, or attract pests. Iron oxide pigments won't fade with extended UV exposure. Meets or exceeds applicable requirements of ASTM C936 and C1782

The Vintage Stone series removes all topography from stone surfaces and joints, creating a smooth and nearly texture-less pavement to evoke clay or draw attention to color patterns and monolithic fields. Vintage is available in a wide range of paver sizes to suit a variety of installation patterns including random runner, repeating runner and ashlar, and single shape patterns. Vintage is suitable for Rumbling, which weathers the paver stones by breaking and softening edges and corners.

### STONE(S)

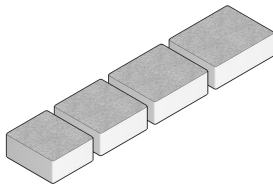

			A	B	C	D
<b>Height</b>	<i>in</i>	In.	2.36	2.36	2.36	2.36
	<i>mm</i>	MM.	60	60	60	60
<b>Length</b>	<i>in</i>	IN.	5.12	5.91	6.69	7.38
	<i>mm</i>	MM	130	150	170	187.5
<b>Width</b>	<i>in</i>	IN	5.91	5.91	5.91	5.91
	<i>mm</i>	MM	150	150	150	150
<b>Units</b>	<i>/pl</i>	QTY	60	100	120	160

### PALLET LAYOUT

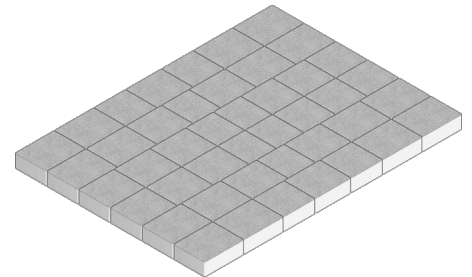

### NOTES

Weights are approximate and do not include shipping pallet. Installation to applicable ICPI standards is required for warranty coverage. Made with natural materials, which vary in color, and Portland cement, which may effloresce - any implied warranty to the contrary is disclaimed.

### PALLET SPECS

<b>Pallet Weight</b>	3248 lbs
<b>Sq Ft/Pallet</b>	116 sq.ft.



[www.pavestone.com](http://www.pavestone.com)